

**ITEM 34. WORKS ZONE – SUSSEX STREET SYDNEY**

**TRIM RECORD NO: 2015/485285**

**RECOMMENDATION**

It is recommended that the Committee endorse the reallocation of the kerb space on the eastern side of Sussex Street, between the points 39.6 metres and 64.2 metres (four car spaces) north of Druitt Place as "Works Zone 7am-7pm Mon-Fri 8am-5pm Sat" and "4P Ticket 8am-10pm Sun & Public Holidays", subject to the following conditions:

- (A) The Applicant must comply with the Street Trees conditions as stipulated in Schedule D of this Agenda.
- (B) The Applicant is not permitted to swing or hoist goods from a Works Zone across or over any part of a public road by means of a lift, hoist or crane unless a separate approval has been obtained from the City's Building Approvals Unit under Section 68 of the Local Government Act 1993.
- (C) Works for major transport projects, such as the Sydney Light Rail Project and the Sydney City Centre Access Strategy, are currently being undertaken in the City's Local Government Area and have priority access and use rights over City owned or controlled land including roads and footpaths. The City may at any time, and with at least 1 business days' notice to the applicant, revoke, suspend or restrict the Works Zone:
  - if the Works Zone is required for a major transport project; or
  - is impracticable due to changes arising from a major transport project, such as traffic diversions; or
  - is otherwise unsuitable due to a major transport project.

The applicant must make its own enquiries, on a regular basis, about the potential impact of major transport projects on the Works Zone and the construction program for its development site.

- (D) The Applicant must notify adjacent properties of the Works Zone at least seven days prior to installation.
- (E) The Applicant must provide a telephone number of the Site Manager.

**DECISION**

**BACKGROUND**

Karimbla Constructions Services (NSW) has requested a 24.6 metre long Works Zone in Sussex Street, Sydney.

The Works Zone is to facilitate construction works at 230-232 Sussex Street, for a period of approximately 26 weeks.

**COMMENTS**

The kerb space on the eastern side of Sussex Street, Sydney north of Druitt Place is currently signposted as “Loading Zone Ticket 7am-6pm Mon-Fri 7am-10am Sat” and “4P Ticket 6pm-10pm Mon-Fri 10am-10pm Sat 8am-10pm Sun & Public Holidays”.

The Works Zone is intended to operate from 7am to 7pm, Monday to Friday and 8am to 5pm on Saturday in accordance with the Development Consent Conditions.

The development site has no provision for off-street parking and as the approved development takes up the entire site, the developer is unable to carry out construction unless a Works Zone is provided directly in front of the site. The street is wide enough to allow the Works Zone to be installed without affecting traffic flow or property access.

The kerb space in the adjacent street is fully allocated with appropriate restrictions so that the temporary loss to parking cannot be replaced.

As there are trees located within, and adjacent to the Works Zone, the applicant must obtain separate approval from the City’s Arboricultural Services Unit.

**CONSULTATION**

The applicant must notify adjacent properties at least 7 days prior to the implementation of the Works Zone.

**FINANCIAL**

All costs associated with the Works Zone will be borne by the Applicant.

**ATTACHMENTS**

Works Zone – Sussex Street Sydney

Sarif Ridoy, Graduate Traffic Engineer

# WORKS ZONE PLAN EXISTING RESTRICTIONS

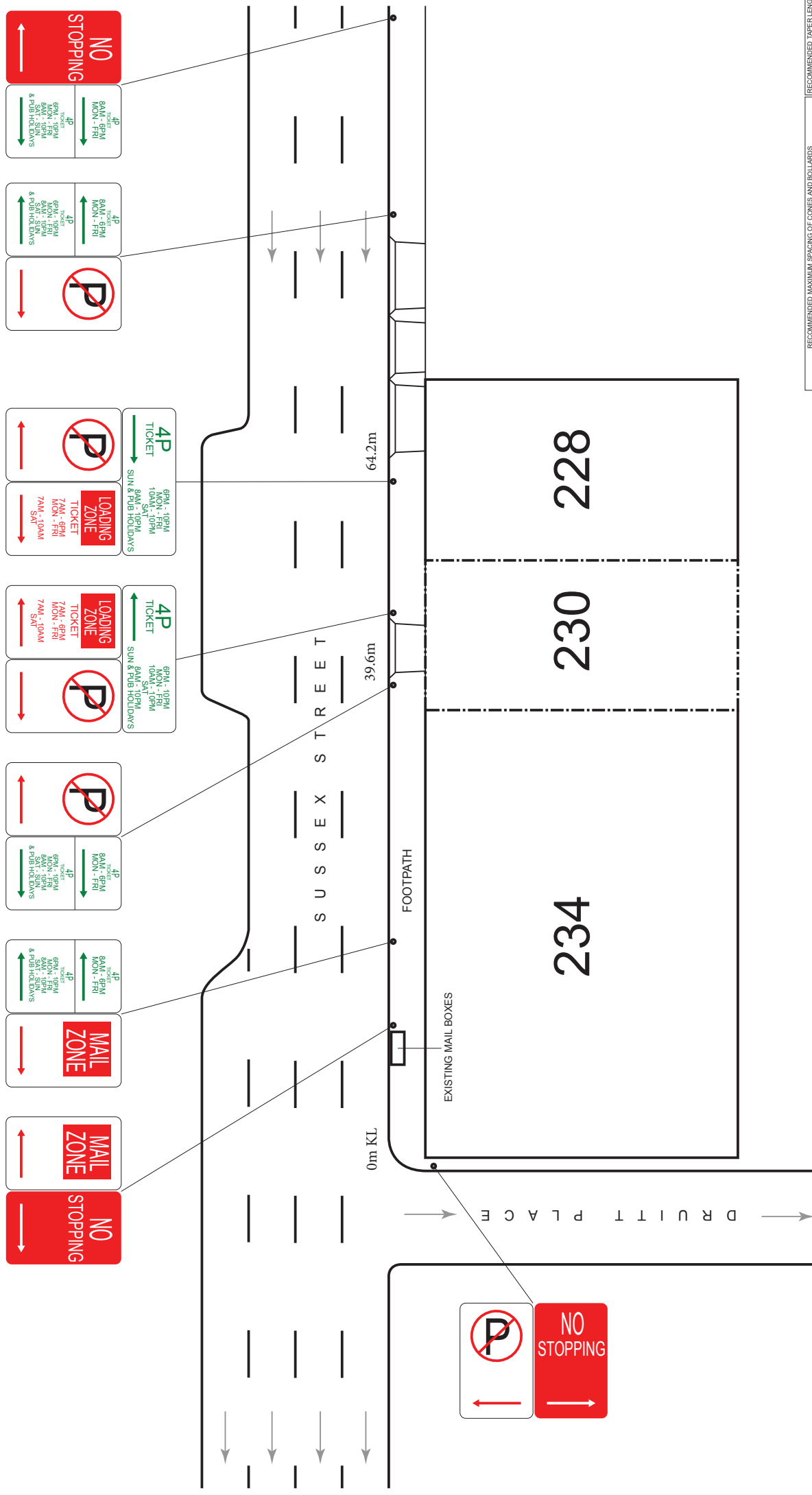

 Strong Pty Ltd ABN: 34 167 185 560 mail@strongmilling.com.au ph: 02 8834 0762 fr: 02 8834 0762	Project/Event:	COMMERCIAL DEVELOPMENT	DESCRIPTION:	
	Location:	230-232 SUSSEX STREET, SYDNEY NSW	DATE:	E
Client:	MERITION		D	PREPARED BY: MATTHEW YOUNG RMS DESIGN & INSPECT TRAFFIC CONTROL PLANS CERTIFICATE No. 2243017038 Expiry: 06/02/2018
Plan No:	SBMG01273-06	A	C	SIGNED:
			B	05/11/15
			A	INITIAL SUBMISSION

RECOMMENDED TAPER LENGTHS	
Approach	Max Spacing (m)
Speed (km/h)	4
<= 50	4
51-70 / >70	18 / 24
> 70	15
Approach	Traffic control
Speed (km/h)	15
< 45	0
46-55	15
56-65	30
66-75	30
76-85	N/A
86-95	N/A
96-105	N/A
> 105	N/A

Traffic Management Plans

# WORKS ZONE PLAN PROPOSED RESTRICTIONS

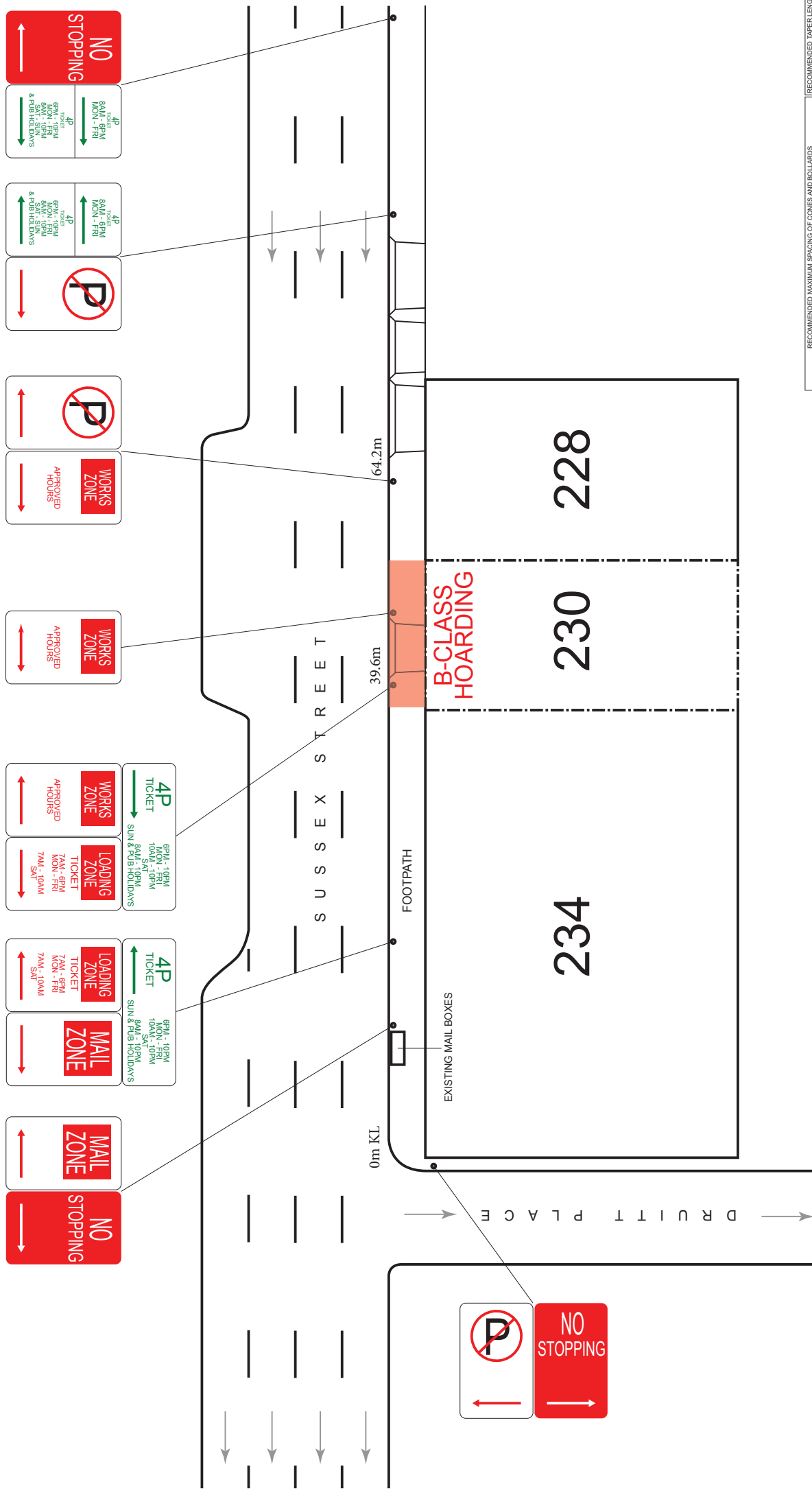

**NO STOPPING** (Red sign with arrow pointing right)

**4P TICKET** (Green sign with arrow pointing right)

8AM - 6PM  
MON - FRI  
SAT - SUN  
& PUB HOLIDAYS

**NO STOPPING** (Red sign with arrow pointing left)

**4P TICKET** (Green sign with arrow pointing left)

8AM - 6PM  
MON - FRI  
SAT - SUN  
& PUB HOLIDAYS

**WORKS ZONE** (Red sign with arrow pointing right)

**APPROVED HOURS** (Red sign with arrow pointing right)

**NO STOPPING** (Red sign with arrow pointing right)

**WORKS ZONE** (Red sign with arrow pointing left)

**APPROVED HOURS** (Red sign with arrow pointing left)

**NO STOPPING** (Red sign with arrow pointing left)

**4P TICKET** (Green sign with arrow pointing right)

8AM - 10PM  
MON - FRI  
SAT - SUN  
& PUB HOLIDAYS

**LOADING ZONE** (Red sign with arrow pointing right)

**TICKET** (Red sign with arrow pointing right)

7AM - 6PM  
MON - FRI  
7AM - 10AM  
SAT - SUN

**4P TICKET** (Green sign with arrow pointing left)

8AM - 10PM  
MON - FRI  
SAT - SUN  
& PUB HOLIDAYS

**LOADING ZONE** (Red sign with arrow pointing left)

**TICKET** (Red sign with arrow pointing left)

7AM - 6PM  
MON - FRI  
7AM - 10AM  
SAT - SUN

**MAIL ZONE** (Red sign with arrow pointing right)

**MAIL ZONE** (Red sign with arrow pointing left)

**NO STOPPING** (Red sign with arrow pointing right)

**NO STOPPING** (Red sign with arrow pointing left)

RECOMMENDED MAXIMUM SPACING OF CONES AND BOLLARDS		RECOMMENDED TAPER LENGTHS	
Purpose an usage	Approach Speed (km/h)	Max Spacing (m)	
All purposes on residential or commercial streets	<= 60	4	Lateral taper
Center line on approach to Traffic Controller position	All Cases	4	Lateral taper
Outer edge of traffic lane - i.e. working on shoulder	51-70 / >70	18 / 24	Approach
Separating opposing traffic on 2 lane 2 way road	< 45	0	Traffic control
Separating opposing traffic on a multilane undivided road	46-55	15	Approach
adjacent to a closed lane on a multilane road	51-70 / >70	12 / 18	Approach
Merge lanes	51-70 / >70	18 / 24	Approach
Lateral shift tapers	66-75	N/A	Approach
Projecting freshly painted lines	76-85	N/A	Approach
Projecting freshly painted lines	86-95	N/A	Approach
Projecting freshly painted lines	96-105	N/A	Approach
Projecting freshly painted lines	106-115	N/A	Approach
Projecting freshly painted lines	116-125	N/A	Approach
Projecting freshly painted lines	126-135	N/A	Approach
Projecting freshly painted lines	136-145	N/A	Approach
Projecting freshly painted lines	146-155	N/A	Approach
Projecting freshly painted lines	156-165	N/A	Approach
Projecting freshly painted lines	166-175	N/A	Approach
Projecting freshly painted lines	176-185	N/A	Approach
Projecting freshly painted lines	186-195	N/A	Approach
Projecting freshly painted lines	196-205	N/A	Approach
Projecting freshly painted lines	> 205	N/A	Approach

DATE	DESCRIPTION
E	
D	
C	
B	
A	INITIAL SUBMISSION

PREPARED BY: MATTHEW YOUNG  
RMS DESIGN & INSPECT TRAFFIC CONTROL PLANS  
CERTIFICATE No. 2243017058  
Expiry: 06/02/2018

SIGNED:

Project/Event:	COMMERCIAL DEVELOPMENT
Location:	230-232 SUSSEX STREET, SYDNEY NSW
Client:	MERITION
Plan No.	SBMG01273-04
Date:	5TH NOVEMBER 2015
Scale:	NOT TO SCALE